

PLAN

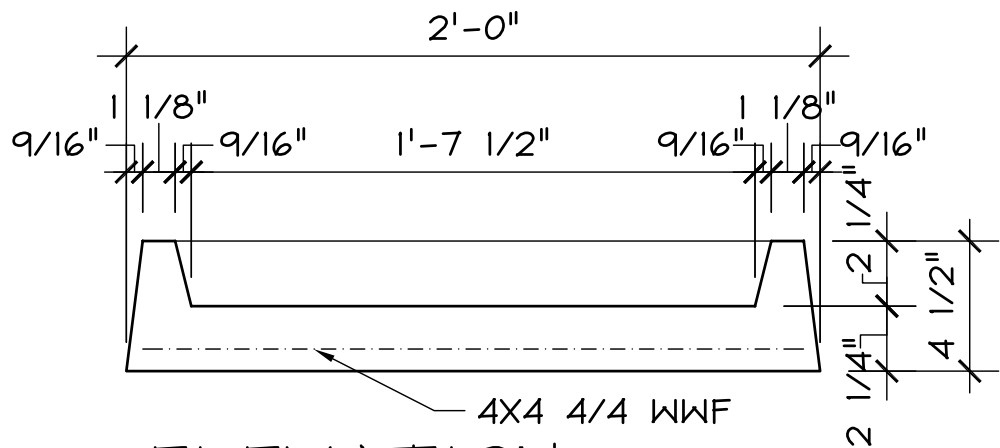

ELEVATION

WEIGHT: 180 #

CONCRETE SPECIFICATIONS:  
 4000 f'c 28-DAY COMPRESSIVE STRENGTH

4-7% ENTRAINED AIR  
 MILD STEEL REINFORCING  
 AS REQUIRED  
 POLYPROPYLENE FIBER  
 SECONDARY REINFORCING

FORMS:  
 SMOOTH SURFACE FIBERGLASS

COLORS:  
 GREY

FINISHES:  
 SMOOTH AS-CAST

24" X 36"  
 SPLASH BLOCK

ARCHITECTURAL PRECAST CONCRETE  
**MATERIALS, INC.**